



⚠ WARNING This equipment should not be installed, operated or maintained by any person who has not read and understood all the contents of this manual. Failure to read and comply with the contents of this manual can result in serious bodily injury or death, and/or property damage. Record the lot and serial number in the space provided below.

Lot Number: _____

Serial Number: _____

Table of Contents

1.0	IMPORTANT INFORMATION AND WARNINGS.....	1
2.0	TECHNICAL INFORMATION.....	2
3.0	PREOPERATIONAL PROCEDURES.....	2
4.0	OPERATION.....	3
5.0	INSPECTION.....	3
6.0	MAINTENANCE.....	5
7.0	WARRANTY.....	6
8.0	PARTS LIST.....	6

1.0 Important Information and Warnings

1.1 Terms and Summary

This manual provides important information for personnel involved with the installation, operation and maintenance of this product. Although you may be familiar with this or similar equipment, it is strongly recommended that you read this manual before installing, operating or maintaining the product.

Danger, Warning, Caution and Notice – Throughout this manual there are steps and procedures that can present hazardous situations. The following signal words are used to identify the degree or level of hazard seriousness.

⚠ DANGER Danger indicates an imminently hazardous situation which, if not avoided, **will** result in **death or serious injury**, and property damage.

⚠ WARNING Warning indicates an imminently hazardous situation which, if not avoided, **could** result in **death or serious injury**, and property damage.

⚠ CAUTION Caution indicates a potentially hazardous situation which, if not avoided, **may** result **minor or moderate injury** or property damage.

NOTICE Notice is used to notify people of installation, operation, or maintenance information which is important but not directly hazard-related.

This manual chain hoist is designed and manufactured to lift and lower a load manually within a normal work environment. Movement in the horizontal direction is also enabled by combining with a trolley. The operation of a hoist involves more than activating the hoist's controls. Per the ANSI/ASME B30 standards, the use of a hoist is subject to certain hazards that cannot be mitigated by engineered features, but only by the exercise of intelligence, care, common sense, and experience in anticipating the effects and results of activating the hoist's controls. Use this guidance in conjunction with other warnings, cautions, and notices in this manual to govern the operation and use of your hoist.

1.2 Shall's and Shall Not's for Operation

⚠ WARNING
Improper operation of a hoist can create a potentially hazardous situation which, if not avoided, could result in **death or serious injury**, and substantial property damage. To avoid such a potentially hazardous situation **THE OPERATOR SHALL:**

- **NOT** use hoist before reading Owner's Manual.
- **NOT** lift more than rated load for the hoist.
- **NOT** operate a hoist which has been modified without the manufacturer's approval or certification to be in conformity with applicable OSHA regs.
- **NOT** operate hoist when it is restricted from forming a straight line from hook to hook in the direction of loading.
- **NOT** use hoist with twisted, kinked, damaged, or worn chain.
- **NOT** use damaged hoist or hoist that is not working properly.
- **NOT** operate a malfunctioning or unusually performing hoist.
- **NOT** use the hoist to lift, support, or transport people.
- **NOT** lift loads over people.
- **NOT** remove or obscure the warnings on the hoist.
- **NOT** use load chain as a sling or wrap load chain around load.
- **NOT** use in a way that causes either hook to be side loaded.
- **NOT** apply the load to the tip of the hook or to the hook latch.
- **NOT** use hoist if hook latch is missing or malfunctioning.
- **NOT** apply load unless load chain is properly seated in the load sheave.
- **NOT** use the hoist in such a way that could result in shock or impact loads being applied to the hoist.
- **NOT** attempt to lengthen the load chain or repair damaged load chain or hand chain.
- **NOT** operate beyond the limits of the load chain travel.
- **NOT** leave load supported by the hoist unattended unless specific precautions have been taken.
- **NOT** allow the chain, or hook to be used as an electrical or welding ground.
- **NOT** allow the chain, or hook to be touched by a live welding electrode.
- **NOT** operate a hoist on which the safety placards or decals are missing or illegible.
- Be familiar with operating controls, procedures, and warnings.
- Make sure the unit is securely attached to a suitable support before applying load.
- Make sure load slings or other approved single attachments are properly sized, rigged, and seated in the hook saddle.
- Take up slack carefully - make sure load is balanced and load-holding action is secure before continuing.
- Make sure all persons stay clear of the supported load.
- Protect the hoist's load chain from weld splatter or other damaging contaminants.
- Report Malfunctions or unusual performances (including unusual noises) of the hoist and remove the hoist from service until the malfunction or unusual performance is resolved.
- Warn personnel before lifting or moving a load.
- Warn personnel of an approaching load.

7.0 Warranty

All products sold by Harrington Hoists, Inc. are warranted to be free from defects in material and workmanship from date of shipment by Harrington for the following periods:

- 1 year – Electric and Air Powered Hoists (excluding (N)ER2 Enhanced Features Models), Powered Trolleys, Powered Tiger Track Jibs and Gantries, Crane Components, Sling Chain, Spare / Replacement Parts**
- 2 years – Manual Hoists & Trolleys, Beam Clamps**
- 3 years – (N)ER2 Enhanced Features Model Hoists**
- 5 years – Manual Tiger Track Jibs and Gantries, TNER Pull - Rotor Motor Brake**
- 10 years – (N)ER2 “The Guardian” Smart Brake**

The product must be used in accordance with manufacturer's recommendations and must not have been subject to abuse, lack of maintenance, misuse, negligence, or unauthorized repairs or alterations.

Should any defect in material or workmanship occur during the above time period in any product, as determined by Harrington Hoist's inspection of the product, Harrington Hoists, Inc. agrees, at its discretion, either to replace (not including installation) or repair the part or product free of charge and deliver said item F.O.B. Harrington Hoists, Inc. place of business to customer.

Customer must obtain a Return Goods Authorization as directed by Harrington or Harrington's published repair center prior to shipping product for warranty evaluation. An explanation of the complaint must accompany the product. Product must be returned freight prepaid. Upon repair, the product will be covered for the remainder of the original warranty period. Replacement parts installed after the original warranty period will only be eligible for replacement (not including installation) for a period of one year from the installation date. If it is determined there is no defect, or that the defect resulted from causes not within the scope of Harrington's warranty, the customer will be responsible for the costs of returning the product.

Harrington Hoists, Inc. disclaims any and all other warranties of any kind expressed or implied as to the product's merchantability or fitness for a particular application. Harrington will not be liable for death, injuries to persons or property or for incidental, contingent, special or consequential damages, loss or expense arising in connection with the use or inability whatever, regardless of whether damage, loss or expense results from any act or failure to act by Harrington, whether negligent or willful, or from any other reason.

8.0 Parts List

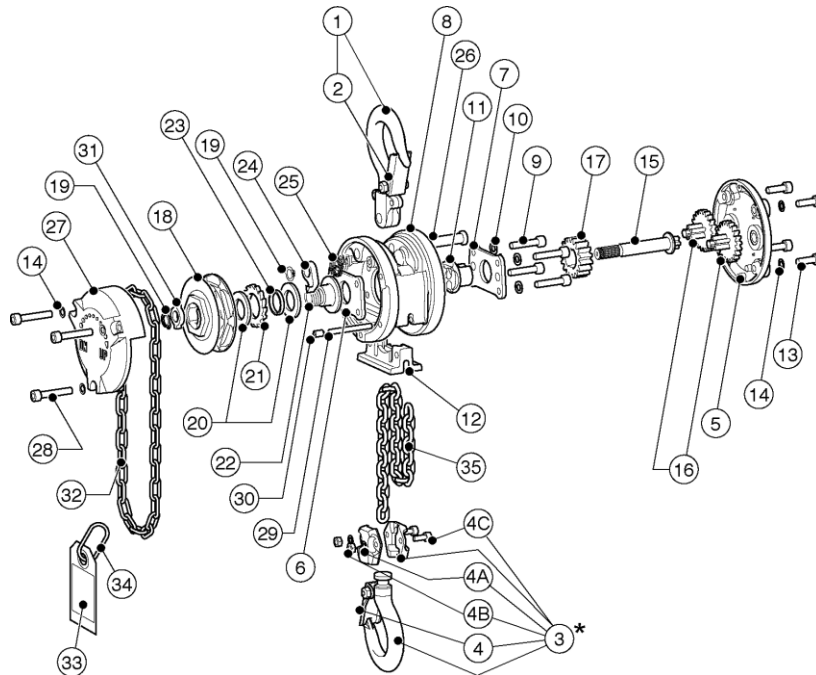

- * Bottom Hook Fasteners:
 – Torque to 40 – 48 lb_f-in.
 – Use Loctite® Threadlocker 241 or 242.

Figure No.	Part Name	Parts Per Hoist	Part Number
1	Top Hook Assembly	1	L1XA0031001
2	Latch Assembly	1	L1XA0031071
3 *	Bottom Hook Assembly	1	L1XA0031021
4	Latch Assembly	1	L1XA0031071
4A	Spring Lock Washer	2	9012707
4B	Hex Nut	2	9093414
4C	Socket Head Cap Screw	2	9091203
5	Gear Case Assembly with Nameplate	1	C1XU0035103
6	Frame A	1	C1XA0039101
7	Frame B	1	C1XA0039102
8	Body Assembly	1	C1XA0036104
9	Socket Head Cap Screw	4	9091330
10	Spring Lock Washer	4	9798003
11	Load Sheave	1	C1XA0039116

Figure No.	Part Name	Parts Per Hoist	Part Number
12	Chain Guide	1	C1XA0039162
13	Socket Head Cap Screw	4	9091328
14	Conical Lock Washer	7	C1XA0039109
15	Pinion	1	C1XA0039111
16	Gear #2	2	C1XA0039112
17	Load Gear	1	C1XA0039114
18	Hand Wheel Assembly w/Load Limiter	1	C1XA0035115
19	Snap Ring	2	9047109
20	Friction Plate	2	C1XA0039151
21	Ratchet Disc	1	C1XA0039152
22	Friction Disc	1	C1XA0039153
23	Bushing	1	C1XA0039154
24	Pawl	1	C1XA0039155

Figure No.	Part Name	Parts Per Hoist	Part Number
25	Pawl Spring Assy (2 springs)	1	C1XA0031158
26	Top Pin	1	C1XA0039163
27	Wheel Cover	1	C1XA0039171
28	Socket Head Cap Screw	3	9091331
29	End Pin	1	C1XA0039177
30	Hexagon Socket Set Screw	1	J1TB01105008
31	Cam Guide	1	C1XA0039203
32 **	Hand Chain - For 8 or 10 Ft Lift	1	6085301
	Hand Chain - For 20 Ft Lift	1	6085302
33	Warning Tag	1	WTAG9
34	Chain Stopper Link	1	L5BA0089045
35	Load Chain	FT	LCLX003NP

** Other hand chain lengths available – consult Harrington customer service.

Harrington Hoists, Inc.
 401 West End Avenue
 Manheim, PA 17545-1703
 Phone: 717-665-2000
 Toll Free: 800-233-3010
 Fax: 717-665-2861

HARRINGTON
 HOISTS AND CRANES

www.harringtonhoists.com

Harrington Hoists - Western Division
 2341 Pomona Rincon Rd. #103
 Corona, CA 91720-6973
 Phone: 951-279-7100
 Toll Free: 800-317-7111
 Fax: 951-279-7500

CXOM